

StoTherm Classic®

The technologically superior
external wall insulation system

StoTherm Classic® has been tried and tested in practical application for over 40 years and has undergone continuous further development during this time. One of the most successful facade insulation systems provides maximum system reliability and endurance – proven by almost 100 million square metres of reference surface and a technical complaint rate of near zero. The cement-free system provides up to 10 times more resistance to shock and impact than mineral systems. It guarantees maximum resistance to cracking and consists of absolutely cement-free system components throughout.

StoTherm Classic® external wall insulation system

Organic system with polystyrene insulation,
limited combustibility



System advantages

- Highly mechanically resistant
- Proven system – more than 100 million m² of reference surface
- Crack-proof due to organic coating build-up
- Highly resistant to microorganisms (algae and fungi)
- Intense, dark colour shades possible
- Cement-free, ready-to-use system components
- Can be applied without intermediate coat and paint coat
- Clean construction sites thanks to the use of Sto-Turbofix – the PU foam-based bonding method
- Resistant to hail, driving rain, and hurricanes according to the FIBAG simultaneous test
- Highly weather-resistant
- Permeable to water vapour and CO₂

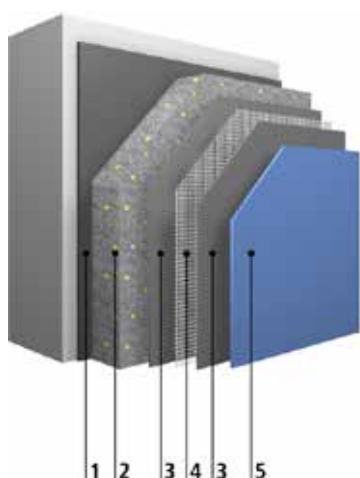

- 1 Adhesive**
Sto-ADH-B, Sto-Turbofix, or
Sto-Dispersion Adhesive
- 2 Insulation**
Sto-EPS Board
- 3 Reinforcement**
StoArmat Classic
- 4 Reinforcing mesh**
Sto-Glass Fibre Mesh
- 5 Finish**
StoLotusan® K/M

Overview of StoTherm Classic®

| | |
|-----------------------------|---|
| Areas of application | <ul style="list-style-type: none"> • New and existing buildings up to high-rise level • Suitable for passive house standard |
| Substrate | <ul style="list-style-type: none"> • Masonry such as brick, calcium silicate masonry units, cellular concrete, fair-faced masonry and masonry veneer • Concrete, concrete slab construction (three-layer concrete slabs) • Timber construction (solid, frame, and panel construction) • Steel construction (column and framing) • Existing external wall insulation systems (doubling-up) |
| Fixing | <ul style="list-style-type: none"> • Adhesive bonding • Bonding and dowelling • Purely mechanical fixing |
| Thermal protection | <ul style="list-style-type: none"> • Insulation board made of EPS up to 400 mm |
| Reaction to fire | <ul style="list-style-type: none"> • Limited combustibility • Classe B, C in accordance with EN 13501-1, depending on the system build-up • Additional fire protection measures may be required |
| Impact resistance | <ul style="list-style-type: none"> • High mechanical resistance, up to 15 joules in standard build-up • Resistant up to 60 joules with highly impact-proof build-up • Highest hail resistance class 5 with the appropriate system build-up • Ball-impact resistant in accordance with DIN 18032-3 • Resistant to hail, driving rain, and hurricanes according to the FIBAG simultaneous test |
| Design options | <ul style="list-style-type: none"> • Organic and silicone resin renders, render with Lotus-Effect® Technology in stippled or rilled textures or as free-style textured render • Resin brick slips and 3D facade elements made of Verolith granulate • Natural stone tiles, brick slips, and ceramic tiles possible following agreement |
| Colour range | <ul style="list-style-type: none"> • Tintable in accordance with the StoColor System • Light reflectance value < 25 % possible |
| Application | <ul style="list-style-type: none"> • Cement-free, ready-to-use system components • No intermediate coat required • A double coat of paint offers special protection against algae and fungi • Suitable for application by machine • QS technology makes it possible to carry out projects during the colder seasons |
| Approvals | <ul style="list-style-type: none"> • The relevant European and/or national approvals apply |

Headquarters

Sto SE & Co. KGaA

Market Development

Ehrenbachstraße 1
79780 Stuehlingen

Phone +49 7744 57-1131

Fax +49 7744 57-2428

infoservice@sto.com

www.sto.com



The concrete technical specifications and information on the products contained in the Technical Data Sheets and system descriptions/approvals must be observed.